

RJ45 CONNECTION FOR USE WITH WALL SWITCH AND CAT5E CABLE

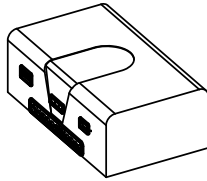

RJ45 CONNECTION FOR USE WITH WIFI MODULE

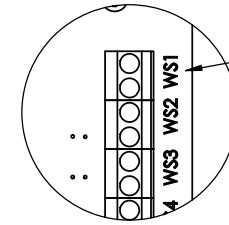
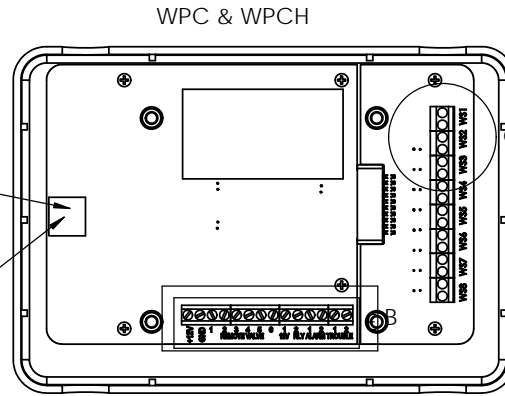

HARD WIRED SENSOR (10' CABLE) ATTACHED HERE

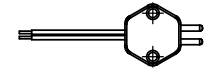

WIRING GUIDE

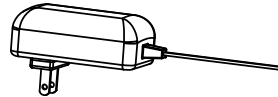
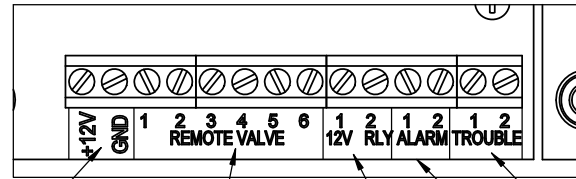

POWER SUPPLY (20' CABLE)
NOTE POLARITY STRIPED WIRE IS ATTACHED TO +12V TERMINAL

WPACT12V ACTUATOR
1 BLACK
2 RED
3 GREEN
4 BROWN
5 WHITE
6 BLUE

DRY CONTACT SIGNAL DURING ALERTS

DRY CONTACT SIGNAL DURING ALARMS

12 VDC SIGNAL WHEN THE UNIT DISPLAYS WATER IS OFF FOR USE WITH REMOTE RELAY



WPACT12V AVAILABLE WITH 25, 50 OR 75' CABLE

NOTE: WHEN USING WPC OR WPCB TO ONLY CONTROL A REMOTE RELAY (NO WPACT12V ATTACHED) JUMPER WIRES MUST BE ATTACHED AS SHOWN BELOW

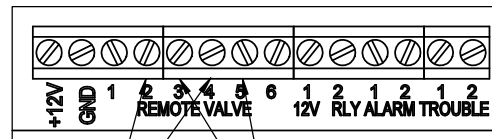

JUMPER WIRE BETWEEN 2 & 4

JUMPER WIRE BETWEEN 3 & 5